

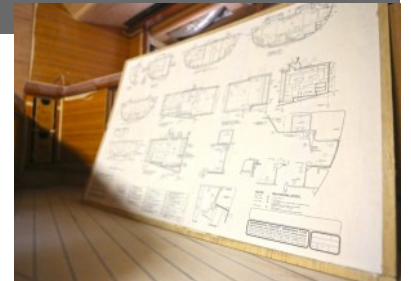

Warwick 75

POA - Must be sold



Specifications

Boat Details

Price	POA - Must be sold	Boat Brand	Warwick
Model	CUSTOM	Length	22.86
Year	2013	Category	Cruising Yachts
Hull Style	Single	Hull Type	Fibreglass
Power Type	Sail	Stock Number	0
Condition	Used	State	New Zealand
Suburb	New Zealand	Engine Make	Yanmar

Disclaimer

Our company offers the details of this vessel in good faith but cannot guarantee or warrant the accuracy of this information nor warrant the condition of the vessel. A buyer should instruct his agents and/or surveyors to investigate such details buyer desires validated. This vessel is offered subject to prior sale, price change or withdrawal without notice.

Description

This is one of two cruising yachts designed and developed for an extremely experienced Hong Kong based yachtsman. With work commencing in Taiwan and then shipped to NZ for completion she will soon be ready for you to start cruising.

This yacht represents the latest Warwick design with very elegant contemporary lines and fast comfortable passagemaking for six to eight passengers and two crew. You can still have input as to the finishing touches to personalise to your desires

Features

Designer	WARWICK
Hull Construction Material	Carbon Composite
Hull Type	Mono
Deck Construction Material	Composite
Country Origin	Auckland, NZ
Beam/Width (m)	5.9
Draft (m)	3.4
Keel/Ballast	11kg
Number Of Engines	1 x Yanmar 245hp
Engine Hours	new
Horse Power (hp)	245
Generator	25 kw
Fuel Type	diesel
Fuel Tank Capacity (L)	2000

Engine Details

Engine Make	Yanmar
Engine Hours	new
Horse Power	245
Fuel Type	diesel
Drive Type	4
Fuel Capacity	2000

Disclaimer

Our company offers the details of this vessel in good faith but cannot guarantee or warrant the accuracy of this information nor warrant the condition of the vessel. A buyer should instruct his agents and/or surveyors to investigate such details buyer desires validated. This vessel is offered subject to prior sale, price change or withdrawal without notice.